

## File Cabinet Locks

- Four pin tumbler plug.
- Die cast barrel with die cast bolt.
- Brushed Chrome



Chicago

Mfg #	Image	Dimensions	Length	Bolt	Keying	EZ #
C5001 50L KA1X20			1-3/4"	Round	Keyed Alike KA1X20	002529
C5001 50L KD			1-3/4"	Round	Keyed Different	002530
C5002LP KA1X20 99332			1-3/4"	Round	Keyed Alike KA1X20	002527
C5001LP KD			1-3/4"	Round	Keyed Different	002528
C5002LP KD			2"	Square	Keyed Different	002534
C5002LP KA1X20			2"	Square	Keyed Alike KA1X20	026195
CEXP19 KA5X75			1-1/2"	Round	Keyed Alike KA5X75	091429
CEXP19 KD			1-1/2"	Round	Keyed Different	002418

## Single Pole Single Throw Switch Locks

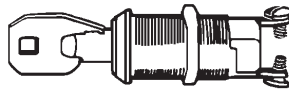
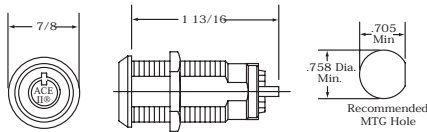

Mfg #	EZ #
C4073 70DC KD	074966

- Momentary contact Ace II® switch locks feature spring return from closed to open position after 90° clockwise key rotation to closed position.
- 7 amps (resistive) @ 125 Volts A.C., 7 amps @ 28 Volts D.C.
- Electrical Life: 6,000 cycles @ Max. Load.
- Contact Resistance: 50 milliohms initial maximum.
- Stocked Keyed Different in Bright Chrome.

## "T" Handle Cylinder Locks

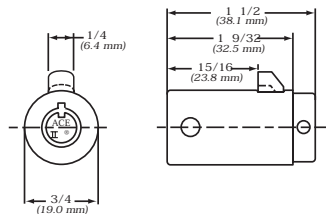

- 7 Pin tumbler Ace II®
- Brass locking bolt.
- Set screw hole for anti-pull feature when used in "T" Handle with set screw feature.
- Standard finish — Chrome
- The "T" Handle units both screw-in and cam-latching are available by special order.

Mfg #	Keying	EZ #
C425519RL KASP802	Keyed Alike KASP802	077114
C425519RL KD	Keyed Different	002526