

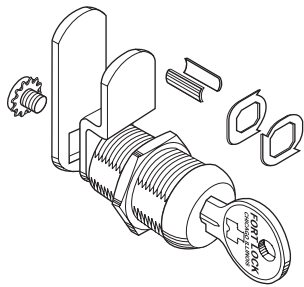

Single Bitted Cam Lock with Universal Keyway



Universal Keyway covers 9 key sections from various manufacturers.

MULTI-FUNCTION

Mfg #	Length	Finish	Keying	EZ #
MFW23038KD	7/16"	Brass	KD	003850
MFW23058KD	5/8"	Brass	KD	003853
MFW23078KA221	7/8"	Brass	KA 221	003855
MFW24038KACAT60	7/16"	Stainless	CAT60	039131

Single Bitted Drawer Lock with Universal Keyway

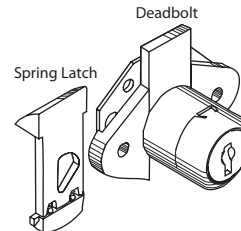

MULTI-FUNCTION

Mfg #	Length	Finish	Keying	EZ #
MFW23006BKD	3/4"	Brass	KD	039124
MFW23006KD	3/4"	Stainless	KD	039148
MFW23007BKA221	7/8"	Brass	KA 221	003841

Single Bitted Metal Drawer Lock

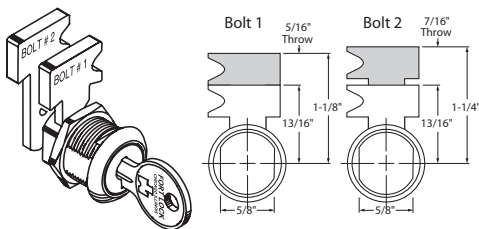

- 2 Bolt Throw Heights
- Key removable in locked or unlocked position

Mfg #	EZ #
MFW3010KD	003843

Specialty Cams

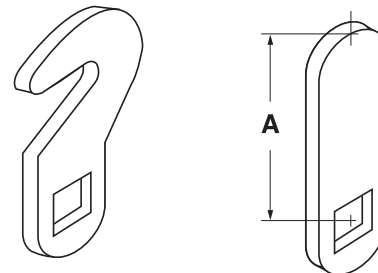

Threaded Shaft Lock

- 'A' Dimension: 8"
- 'B' Dimension: 5/8"
- 'C' Dimension: 1-1/2"
- Key pulls at 12 & 6
- Gem 7 pin tumbler security lock

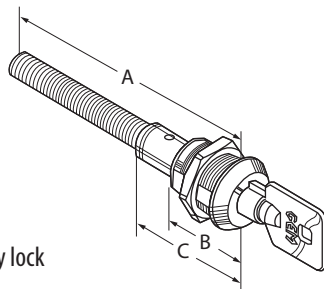

Mfg #	Keying	EZ #
TS1058BD KA27379	KA 27379	039991
TS1058BD KD	KD	003906

Mfg #	Type	Length	EZ #
1864472419	Hook	1-7/8"	039120
201 [FTLK]	Hook	1-3/4"	039122
500	Double End	1-1/8" Each	039146
SF2200	Straight	1 3/8"	039164
SF2400	Straight	1 1/2"	039165
SF2800	Straight	1 3/4"	039166
SF3200	Straight	2"	084879
SF4000	Straight	2 1/2"	039167
SF4800	Straight	3"	070294



Fort Lock

Multifunction 7 Pin Tumbler Cam Locks

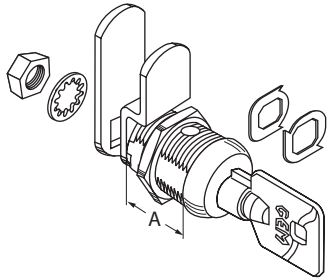

MULTI-FUNCTION

MFW1078

Mfg #	Size 'A'	Keying	EZ #
MFW1058KA27379	25/32"	KA 27379	003830
MFW1078KA27379	15/16"	KA 27379	026374
MFW1118KA27379	1-5/32"	KA 27379	026377

Multifunction 7 Pin Tumbler Switch Locks

MULTI-FUNCTION

- UL Rated Rekeyable Switch Lock
- Functions: Maintaining & Momentary Contact, Single Pole, Double Throw Switch,
- Rating: 125/250VAC @ 7A (Resistive Load)
- Lead Length 10"
- 'A' Dimension 1-3/8"

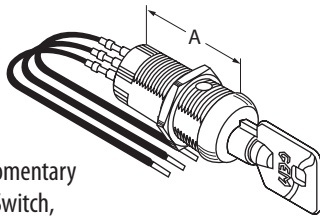

MFSW3 1138

Mfg #	Keying	EZ #
MFSW3 1138KD	KD	026358
MFSW31138KA27379	KA 27379	003823

Replacement Plug for Old Ilco 752 Mailbox Locks

8078

Mfg #	EZ #
8078	035529



Wood & Glass Showcase Locks

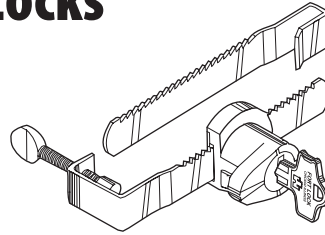

MFWSG29000

- 2 One-Way Bars, Wood & Glass
- Removable cylinder for Rekeying
- Anti-Spread Housing

Mfg #	Keying	EZ #
MFWSG29000KA3085	KA 3085	027911
MFWSG29000KD	KD	003825

Keying Kits, Follower, & Anchor Plate & Plate



- AP1**
- Cam lock anchor plate
 - .630 Flats



RKK130

- Universal wafer kit for MFW23000 & MFW24000



MF1

- Following Tool

Mfg #	Description	EZ #
AP1	Camlock Anchor Plate	030074
MF1	Plastic Plug Follower	035527
RKK130	Wafer Kit for MFW23/24000	026363
RKK110	Pin Kit for MFW1000 Series	026360